

Technical drawing of a roof structure (Dachstuhl) showing a cross-section with various dimensions and labels. The drawing includes a side elevation and a plan view. The side elevation shows a gabled roof with a peak height of 4000 mm. The plan view shows the roof layout with dimensions for the eaves (Traufe) and the ridge (First). The drawing is labeled with 'Dachstuhl' and 'Dachstuhl'.

[illegible]

Technical drawing of a roof truss (Trabea Anbau 6730) showing a cross-section with dimensions and reinforcement details. The drawing includes the following elements:

- Dimensions:**
  - Overall width: 21000
  - Overall height: 2500
  - Span between supports: 20700
  - Horizontal spacing between vertical supports: 5175 (repeated four times)
- Reinforcement Details:**
  - Top reinforcement: 0.75mm<sup>2</sup> 21000mm
  - Bottom reinforcement: 0.75mm<sup>2</sup> 21000mm
  - Diagonal bracing: 2xφ16
- Labels and Markings:**
  - Trabea Anbau 6730
  - 0.250
  - Support markers: 3, 4, 5, 6, 7

Technical drawing of a roof truss (Dachstuhl) showing a cross-section. The drawing includes the following dimensions and labels:

- Top horizontal dimension: 10205
- Left vertical dimension: 5285
- Bottom horizontal dimension: 10460
- Right vertical dimension: 5175
- Diagonal dimension (red line): 1mm/10205mm
- Label: Traufe Anbau 6730
- Label: 0 250
- Section line symbols (circles with dots) are present along the edges.
- Reference markers 1, 2, and 3 are located at the bottom.

Technical drawing of a wall section showing acoustic insulation (Akustikblech) and structural details. The drawing includes dimensions for height (5490, 5540, 5670) and width (5780, 5790, 5680). It also shows a sloped roof structure with dimensions like 1mm 5469mm, 1mm 5400mm, 1mm 4340mm, 1mm 5470mm, 1mm 230mm, and 1mm 300mm. The drawing is labeled "First Anbau 9079.1" and "Traufe Anbau 6730".

Technical drawing of a bridge structure, showing a plan view and a cross-section.

**Plan View (Top):**

- Bridge deck width: 5280mm
- Distance between piers (from right to left): 5280mm, 15515mm, 15510mm, 17210mm, 5845mm.
- Dimensions for the bridge deck and piers are provided in millimeters (mm).

**Cross-Section (Bottom):**

- Bridge deck width: 5280mm
- Bridge height: 12330mm
- Dimensions for the bridge deck and piers are provided in millimeters (mm).

The drawing includes a scale bar and a north arrow.

Technical drawing of a roof structure (Dachstuhl) showing a side elevation. The drawing includes dimensions for various components and annotations for construction details.

**Dimensions and Annotations:**

- Top Chords (Traufe 12330):**
  - Segment 1: 5280 (1mm\* 5280mm)
  - Segment 2: 15515 (0.75mm\* 15515mm)
  - Segment 3: 15510 (0.75mm\* 15510mm)
  - Segment 4: 17210 (0.75mm\* 17210mm)
  - Segment 5: 5845 (0.88mm\* 5845mm)
- Internal Trusses:**
  - Truss 1: 0.75mm\* 17184mm
  - Truss 2: 0.88mm\* 5845mm
- Bottom Chords (Traufe Anbau 6730):**
  - Segment 1: 5280
  - Segment 2: 15515
  - Segment 3: 15510
  - Segment 4: 17210
  - Segment 5: 5845
- Vertical Dimensions (Right Side):**
  - Top Chord: 12330
  - First Anbau: 9079.1
  - Traufe Anbau: 6730
  - Bottom Chord: 250
- Horizontal Dimensions (Bottom):**
  - 5280
  - 15515
  - 15510
  - 17210
  - 5845
- Annotations:**
  - 1mm\* 5280mm (Top Chord 1)
  - 0.75mm\* 15515mm (Top Chord 2)
  - 0.75mm\* 15510mm (Top Chord 3)
  - 0.75mm\* 17210mm (Top Chord 4)
  - 0.88mm\* 5845mm (Top Chord 5)
  - 0.75mm\* 17184mm (Internal Truss 1)
  - 0.88mm\* 5845mm (Internal Truss 2)
  - 12330 (Top Chord Height)
  - 9079.1 (First Anbau Height)
  - 6730 (Traufe Anbau Height)
  - 250 (Bottom Chord Height)

Die Ausführung der Kassettenwand erfolgt mit Profilen der Firma Salzgitter in unterschiedlichen Profilstärken. Die Kassettenbreite entspricht 100mm, die Höhe 600mm.

### Kassettenbefestigung

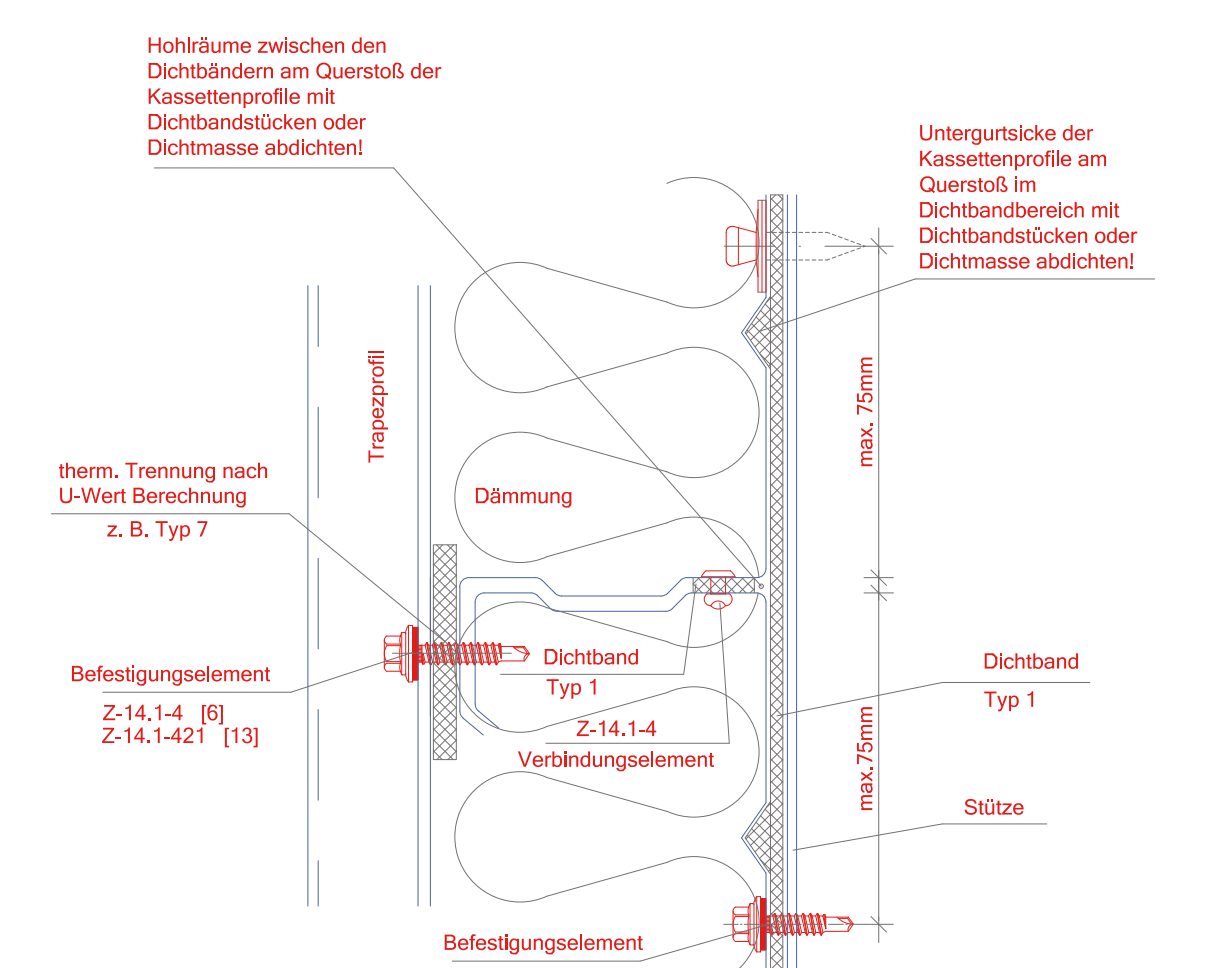

The image contains two technical drawings of a Kassetten-Decke (cassette ceiling).

**Left Drawing (Perspective View):** This drawing shows a grid of ceiling cassettes. Labels include:
 

- Verbindungsmittel für Auflager (Schnäbel oder Sechskant) - Connection means for support (beaks or hexagons)
- Verbindungsmittel für Steg - Connection means for the bridge
- Längsstütz - Longitudinal support
- Dachrand - Roof edge
- konstruktive Verbindungen - Constructive connections
- Untergurt - Under-rib
- Steg - Bridge
- Obergurt - Upper rib
- Steghöhe - Bridge height
- Querstütz - Transverse support
- Kassette - Cassette
- Deckenrand - Ceiling edge
- Auflager - Support
- Deckenbreite - Ceiling width

**Right Drawing (Cross-section View):** This drawing shows the vertical structure of the ceiling. Labels include:
 

- Wärmedämmung - Thermal insulation
- Kassette - Cassette
- thermische Trennung - Thermal separation
- Außenschale vertikal angelegt - Outer shell installed vertically